

User Guide

# The Infra Red Remote Control 1094FR

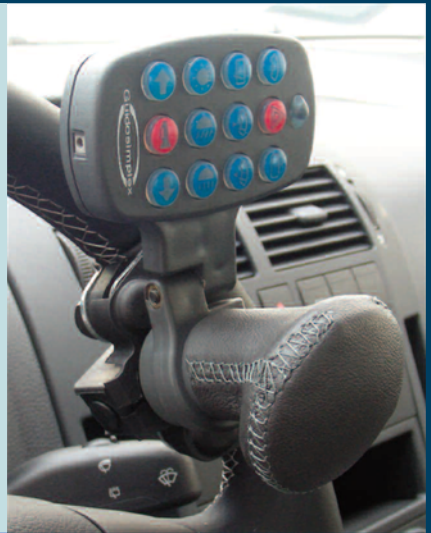

NUEVOS  
TALLERES  CODA

<https://nuevostallerescoda.com/>

**Dear Customer,**

Thank you for having purchased a Guidosimplex device, the 1004FR. As with all of our products, this device, was designed and created respecting the highest possible levels of quality and safety standards.

All Guidosimplex products are manufactured from the best materials available on today's market , this means that when you buy a Guidosimplex product you buy quality and reliability, which results in less maintenance.

Guidosimplex products coexist in perfect harmony in parallel with the original commands and design of the vehicle and conventional driving can be restored on command.

This device is capable of fulfilling all needs as per design as long as a correct usage is performed.

**Therefore we advise you to consult  
the below reported user guide  
prior to using the device.**



## INFRA RED REMOTE CONTROL

The device is made up of the following components:

- **Infra Red Remote Control complete with hand knob**   
(Which is installed on the steering wheel)

- **Car Battery Charger**   
(Charge the battery in the vehicle without having to remove it)

- **Standard Battery Charger**   
(Charge the battery directly from the mains)

- **ECU**  
(Electronic control unit elaborates the signal requested and activates the correct command )

- **Dusk Sensors**  
automatically activate the headlights  
when the available daylight diminishes





## INFRA RED REMOTE CONTROL FUNCTION

- ① Rear Wash-Wipers
- ② Hazard lights
- ③ Windscreen wipers
- ④ Rear windscreen wiper
- ⑤ Progressive wiper speed increase
  - Intermittent
  - 1st level speed
  - 2nd level speed
- ⑥ Progressive wiper speed reduction
  - From 2<sup>nd</sup> to 1<sup>st</sup>
  - From 1<sup>st</sup> to intermittent
  - From intermittent to off
- ⑦ City beam
- ⑧ High beam
- ⑨ Headlights off = Flashes  
Headlights on = Change Headlight module
- ① Left indicator
- ① Horn
- ① Right indicator

1

1

2

## KEYBOARD ILLUMINATION

when visibility is reduced , as is the case with nocturnal driving, the keyboard can be switched on, using the switch positioned on the top of the device, causing the buttons to illuminate.

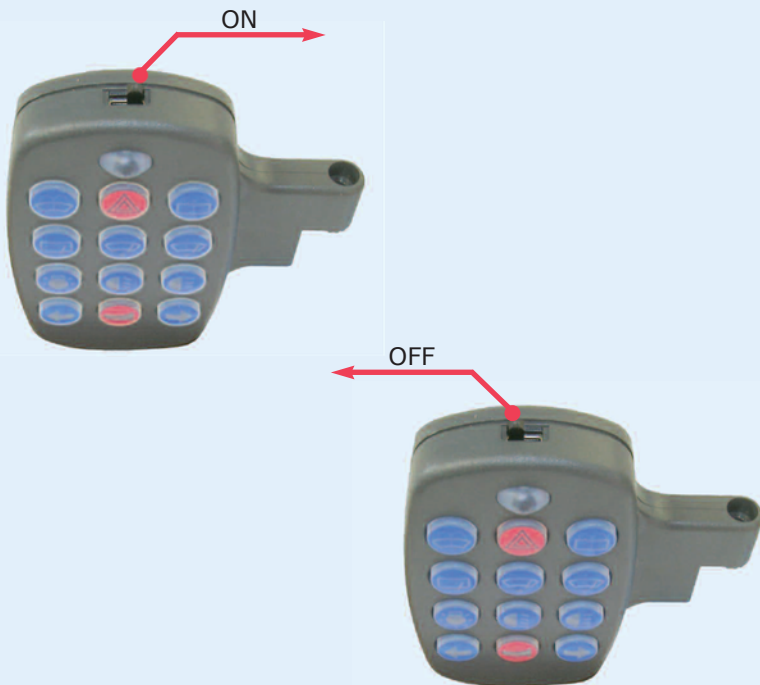

**When this function is no longer required  
the switch must be returned  
to the off position.**

## CHARGING THE BATTERY

### Charging in the vehicle

Charging in the vehicle with a specific lead and pin head, instead of using the standard cigarette lighter we have designed a specific alternative socket, plug in and charge.

Unlike a standard mobile phone charger we have specifically designed this lead to allow the battery to charge when the vehicle is turned off, this lead is designed specifically for the 1094FR and cannot be used any other device

- Plug the lead pin into the device 1
- Plug the lead into the Ad Hoc socket 2
- Charge for between 6-8 hours



**DO NOT CHARGE WHILST DRIVING, THE LEAD MAY INTERFERE WITH STEERING WHEEL FUNCTIONALITY AND THE DEVICE DOES NOT WORK DURING CHARGING. DO NOT CHARGE FOR MORE THAN 8 HOURS**

## CHARGING THE BATTERY

### Charging from the mains

- Push the quick release button to remove the device from the steering wheel **1**
- Plug the lead pin into the device **2**
- Connect the plug to the mains **3**

### Battery replacement

**The battery lifecycle lasts approximately for 800 charges. When replacement of the battery is necessary please contact the nearest authorised GUIDOSIMPLEX DEALER.**

**DO NOT CHARGE FOR MORE THAN 8 HOURS.**



